

## Wine & Liquor Display Fixtures

### Modular Wine & Liquor Displays

For over a quarter century, we have been a leader in the design and manufacture of wine and liquor displays. We continue to develop new designs for displaying bottles upright or laid down. Most of our customers can meet their display needs by choosing from our standard modular designs.

### Custom Wine Displays

If our modular fixtures don't fit your needs, give us some ideas and a sketch of what you have in mind. Often we can alter our standard modular units to fit your merchandising requirements.

### Need help with a fixture layout?

If you are considering purchasing our fixtures, we can help you with fixture layout. Send us a sketch of your retail space with dimensions and indicate the fixtures that meet your needs. Our CAD experts will prepare a drawing to scale and provide a cost estimate. This service is free unless extensive design time is required for custom displays.



Custom Designer's Choice endcap (pages 67-92) used in a wine department in a grocery store.



Custom wine tasting counter used in a wine department in a grocery store.



NEWConcept Gondola starter and add-on units with endcaps (page 166).



Custom wine end cap.



Shelving w/Half-Round Shelf End Caps (pages 125-132).



Combination of NEWConcept units and custom displays for perimeter and floor.

2-sided Tiered Wine Rack with rounded ends (page 174).





NEWConcept back-to-back starters and add-ons with End Cap.



Custom wine end cap.



Heavy Wine/Liquor Shelving with Crown Moulding (page 171).

## NEWConcept Wine Units

Oak and Maple. 3, 4 & 5-level Units w/Shelves, Unit w/Dividers, Gondola (double-sided) and End Cap in a starter and add-on system.

Units w/Dividers offer half-case fronts with four bottles down and two up.

Our NEWConcept Wine System gives the flexibility of custom-built units at an affordable price. Optional signage, Platform Base w/bumper guard and locking glass doors. (Call for optional specifications and pricing.)

Choose moulding pattern and finish. All units ship KD. No UPS.

Wood-grained Melamine is priced with taped edges. Melamine with moulding by quotation.



5-level Unit w/Dividers and Moulding



5-level Unit w/Shelves and Moulding

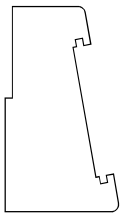

(P#) 5

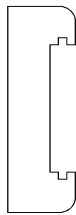

(P#) 6

Optional Tag Moulding for Shelves holds 1-1/4" standard price tags.

## Moulding Pattern Options

NEWConcept Wine Units come with pattern moulding or taped edges. Shelves have wood tag moulding (choose P5 or P6 shown left).

For Units with moulding, Uprights and Panel Caps use 1-3/4" moulding. For Headers, use 6-1/2" moulding (*page 175*).

Units shown use Panel Caps. *See page 175* for other Top Cap options.



3-level Unit w/Dividers, moulding and accent stripe.



Detail of bottles



3-level Gondola w/Dividers and moulding



(6) 5-level Wall Units  
left: with Shelves, right: with Dividers



Starter & Add-on  
NEWConcept Wine Units w/Taped Edges



Heavy Shelf w/P5 Tag Moulding

(2) 3-level Gondolas w/Dividers & (2) 3-level End Caps  
w/Dividers. Dividers create 196 half-case bins.

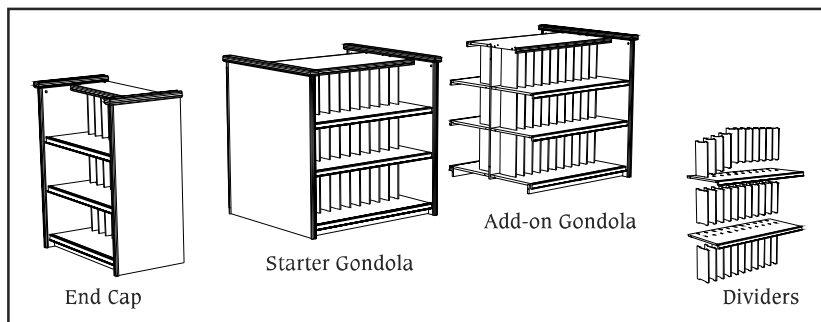

End Cap

Starter Gondola

Add-on Gondola

Dividers

NEWConcept Wine Units and Gondolas use Shelves or Dividers. Dividers create bins that hold 4 bottles down and 2 bottles upright. Use two bins for a case. All ship KD.

NEWConcept Wine Units  
w/custom door kit.



prices: \$ wood / \$ stain / \$ melamine

**NEWConcept Wine Units w/Shelves**

Starter and add-on units with Shelves.  
Available with taped edge or pattern moulding (shown).

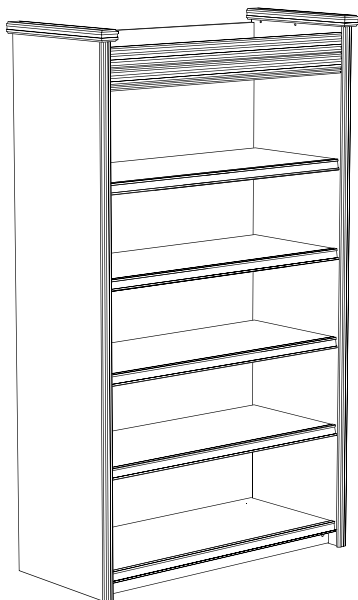

**A. 5-level w/Shelves** – Holds 30 cases  
**Taped Edge**  
Starter: 22" D x 50" W x 92" H  
Add-on: 22" D x 49" W x 92" H  
W\*W-TR50-5LS4HT \$1,260 / \$1,537 / \$807 Str  
W\*W-TR49-5LA4HT \$1,067 / \$1,301 / \$707 Add  
**Pattern Moulding**  
Starter: 23" D x 50" W x 94" H  
Add-on: 23" D x 49" W x 94" H  
W\*W-TR50-5LS4HP# \$1,476 / \$1,800 Str  
W\*W-TR49-5LA4HP# \$1,234 / \$1,505 Add

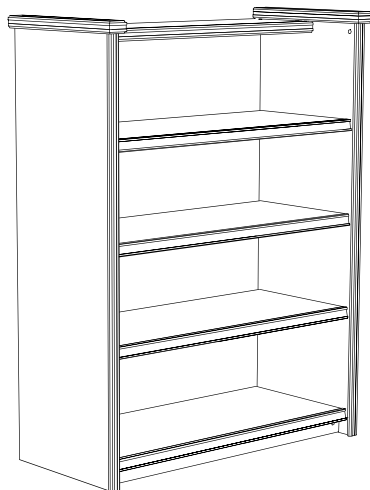

**B. 4-level w/Shelves** – Holds 24 cases  
**Taped Edge**  
Starter: 22" D x 50" W x 68" H  
Add-on: 22" D x 49" W x 68" H  
W\*W-TR50-4LS3HT \$1,053 / \$1,284 / \$703 Str  
W\*W-TR49-4LA3HT \$903 / \$1,101 / \$601 Add  
**Pattern Moulding**  
Starter: 23" D x 50" W x 70" H  
Add-on: 23" D x 49" W x 70" H  
W\*W-TR50-4LS3HP# \$1,203 / \$1,467 Str  
W\*W-TR49-4LA3HP# \$991 / \$1,209 Add



**C. 3-level w/Shelves** – Holds 18 cases  
**Taped Edge**  
Starter: 22" D x 50" W x 52" H  
Add-on: 22" D x 49" W x 52" H  
W\*W-TR50-3LS2HT \$902 / \$1,100 / \$603 Str  
W\*W-TR49-3LA2HT \$784 / \$956 / \$524 Add  
**Pattern Moulding**  
Starter: 23" D x 50" W x 54" H  
Add-on: 23" D x 49" W x 54" H  
W\*W-TR50-3LS2HP# \$993 / \$1,211 Str  
W\*W-TR49-3LA2HP# \$805 / \$982 Add

# See page 175 for moulding patterns and coding instructions

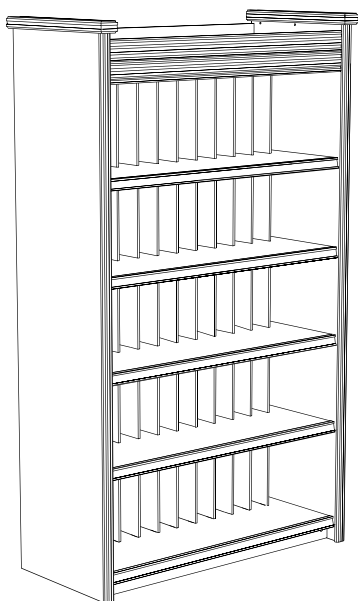

**D. 5-level w/Dividers** – 60 Bins Hold 30 cases  
**Taped Edge**  
Starter: 22" D x 50" W x 92" H  
Add-on: 22" D x 49" W x 92" H  
W\*W-TR50-5LS60BT \$1,731 / \$2,111 / \$1,168 Str  
W\*W-TR49-5LA60BT \$1,559 / \$1,901 / \$1,042 Add  
**Pattern Moulding**  
Starter: 23" D x 50" W x 94" H  
Add-on: 23" D x 49" W x 94" H  
W\*W-TR50-5LS60BP# \$1,948 / \$2,376 Str  
W\*W-TR49-5LA60BP# \$1,701 / \$2,074 Add

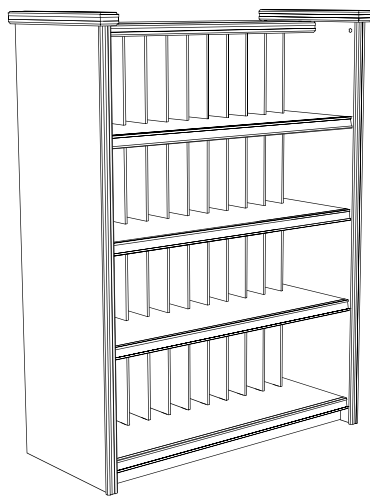

**E. 4-level w/Dividers** – 48 Bins Hold 24 cases  
**Taped Edge**  
Starter: 22" D x 50" W x 68" H  
Add-on: 22" D x 49" W x 68" H  
W\*W-TR50-4LS48BT \$1,469 / \$1,791 / \$982 Str  
W\*W-TR49-4LA48BT \$1,339 / \$1,633 / \$894 Add  
**Pattern Moulding**  
Starter: 23" D x 50" W x 70" H  
Add-on: 23" D x 49" W x 70" H  
W\*W-TR50-4LS48BP# \$1,565 / \$1,909 Str  
W\*W-TR49-4LA48BP# \$1,346 / \$1,641 Add

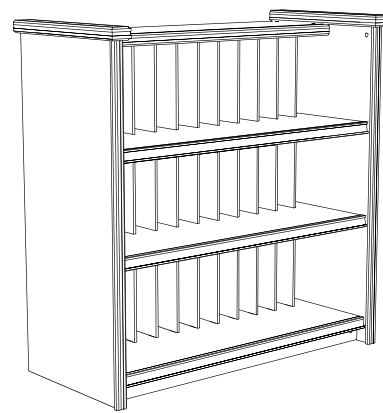

**F. 3-level w/Dividers** – 36 Bins Hold 18 cases  
**Taped Edge**  
Starter: 22" D x 50" W x 52" H  
Add-on: 22" D x 49" W x 52" H  
W\*W-TR50-3LS36BT \$1,059 / \$1,291 / \$708 Str  
W\*W-TR49-3LA36BT \$940 / \$1,146 / \$628 Add  
**Pattern Moulding**  
Starter: 23" D x 50" W x 54" H  
Add-on: 23" D x 49" W x 54" H  
W\*W-TR50-3LS36BP# \$1,267 / \$1,545 Str  
W\*W-TR49-3LA36BP# \$1,103 / \$1,345 Add

**NEWConcept Wine Units w/Dividers**

Starter and add-on units w/Dividers. Dividers create bins to hold 4 bottles down and 2 bottles up.  
Available with taped edge or pattern moulding (shown).

prices: \$ wood / \$ stain / \$ melamine

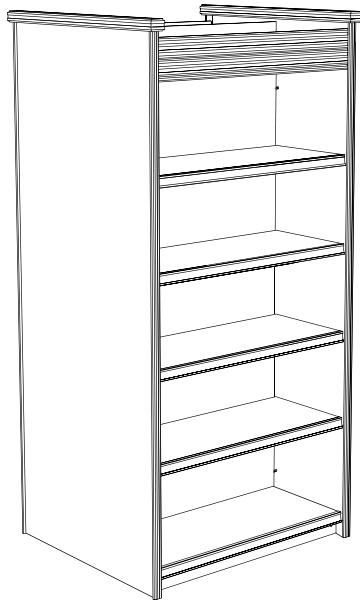

**G. 5-level Gondola w/Shelves** – Holds 60 cases  
**Taped Edge**

Starter: 42" D x 50" W x 92" H  
 Add-on: 42" D x 49" W x 92" H  
 W\*G-TR50-5LS8HT \$2,202 / \$2,685 / \$1,410 Str  
 W\*G-TR49-5LA8HT \$1,870 / \$2,280 / \$1,197 Add  
 End Cap:  
 22" D X 40" W X 91" H – Holds 22-1/2 cases  
 W\*E-TR40-5LE4HT \$981 / \$1,196 / \$628 End Cap  
**Pattern Moulding**  
 Starter: 44" D x 50" W x 94" H  
 Add-on: 44" D x 49" W x 94" H  
 W\*G-TR50-5LS8HP# \$2,597 / \$3,167 Str  
 W\*G-TR49-5LA8HP# \$2,228 / \$2,717 Add  
 End Cap:  
 23" D X 40" W X 91" H – Holds 22 1/2 cases  
 W\*E-TR40-5LE4HP# \$1,181 / \$1,440 End Cap

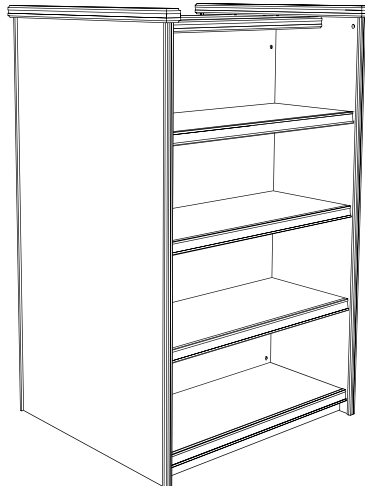

**H. 4-level Gondola w/Shelves** – Holds 48 cases  
**Taped Edge**

Starter: 42" D x 50" W x 68" H  
 Add-on: 42" D x 49" W x 68" H  
 W\*G-TR50-4LS6HT \$1,771 / \$2,160 / \$1,134 Str  
 W\*G-TR49-4LA6HT \$1,508 / \$1,839 / \$965 Add  
 End Cap:  
 22" D X 40" W X 66" H – Holds 18 cases  
 W\*E-TR40-4LE3HT \$771 / \$940 / \$493 End Cap  
**Pattern Moulding**  
 Starter: 44" D x 50" W x 70" H  
 Add-on: 44" D x 49" W x 70" H  
 W\*G-TR50-4LS6HP# \$2,093 / \$2,552 Str  
 W\*G-TR49-4LA6HP# \$1,872 / \$2,283 Add  
 End Cap:  
 23" D X 40" W X 66" H – Holds 18 cases  
 W\*E-TR40-4LE3HP# \$946 / \$1,154 End Cap

**NEWConcept Wine Gondolas w/Shelves**

Starter and add-on gondolas with Shelves. Available with taped edge or pattern moulding (shown).



**I. 3-level Gondola w/Shelves** – Holds 36 cases  
**Taped Edge**

Starter: 42" D x 50" W x 52" H  
 Add-on: 42" D x 49" W x 52" H  
 W\*G-TR50-3LS4HT \$1,438 / \$1,754 / \$920 Str  
 W\*G-TR49-3LA4HT \$1,231 / \$1,501 / \$788 Add  
 End Cap:  
 22" D X 40" W X 50" H – Holds 13-1/2 cases  
 W\*E-TR40-3LE2HT \$601 / \$733 / \$385 End Cap  
**Pattern Moulding**  
 Starter: 44" D x 50" W x 54" H  
 Add-on: 44" D x 49" W x 54" H  
 W\*G-TR50-3LS4HP# \$1,731 / \$2,111 Str  
 W\*G-TR49-3LA4HP# \$1,416 / \$1,727 Add  
 End Cap:  
 23" D X 40" W X 52" H – Holds 13-1/2 cases  
 W\*E-TR40-3LE2HP# \$767 / \$935 End Cap

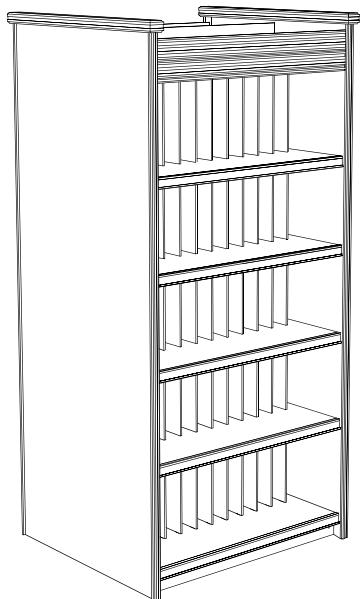

**J. 5-level Gondola w/Dividers**

120 Bins Hold 60 cases  
**Taped Edge**  
 Starter: 42" D x 50" W x 92" H  
 Add-on: 42" D x 49" W x 92" H  
 W\*G-TR50-5LS120BT \$3,068 / \$3,741 / \$1,964 Str  
 W\*G-TR49-5LA120BT \$2,746 / \$3,349 / \$1,757 Add  
 End Cap:  
 22" D X 40" W X 88" H – 45 Bins Hold 22-1/2 cases  
 W\*E-TR40-5L45BT \$1,256 / \$1,532 / \$804 End Cap  
**Pattern Moulding**  
 Starter: 44" D x 50" W x 94" H  
 Add-on: 44" D x 49" W x 94" H  
 W\*G-TR50-5LS120BP# \$3,543 / \$4,321 Str  
 W\*G-TR49-5LA120BP# \$3,091 / \$3,770 Add  
 End Cap:  
 23" D X 40" W X 91" H – 45 Bins Hold 22-1/2 cases  
 W\*E-TR40-5L45BP# \$1,489 / \$1,816 End Cap

**NEWConcept Wine Gondolas w/Dividers**

Starter and add-on gondola w/dividers. Dividers create bins to hold 4 bottles down and 2 bottles up. Available with taped edge or pattern moulding (shown). See page 175 for moulding patterns and coding instructions.



**K. 4-level Gondola w/Dividers**

96 Bins Hold 48 cases  
**Taped Edge**  
 Starter: 42" D x 50" W x 68" H  
 Add-on: 42" D x 49" W x 68" H  
 W\*G-TR50-4LS96BT \$2,491 / \$3,038 / \$1,594 Str  
 W\*G-TR49-4LA96BT \$2,234 / \$2,724 / \$1,431 Add  
 End Cap:  
 22" D X 40" W X 66" H – 36 Bins Hold 18 cases  
 W\*E-TR40-4L36BT \$1,034 / \$1,261 / \$661 End Cap  
**Pattern Moulding**  
 Starter: 44" D x 50" W x 70" H  
 Add-on: 44" D x 49" W x 70" H  
 W\*G-TR50-4LS96BP# \$2,858 / \$3,485 Str  
 W\*G-TR49-4LA96BP# \$2,478 / \$3,022 Add  
 End Cap:  
 23" D X 40" W X 68" H – 36 Bins Hold 18 cases  
 W\*E-TR40-4L36BP# \$1,198 / \$1,461 End Cap



**L. 3-level Gondola w/Dividers**

72 Bins Hold 36 cases  
**Taped Edge**  
 Starter: 42" D x 50" W x 52" H  
 Add-on: 42" D x 49" W x 52" H  
 W\*G-TR50-3LS72BT \$1,949 / \$2,377 / \$1,554 Str  
 W\*G-TR49-3LA72BT \$1,732 / \$2,112 / \$1,281 Add  
 End Cap:  
 22" D X 40" W X 50" H – 27 Bins Hold 13-1/2 cases  
 W\*E-TR40-3L27BT \$821 / \$1,001 / \$637 End Cap  
**Pattern Moulding**  
 Starter: 44" D x 50" W x 54" H  
 Add-on: 44" D x 49" W x 54" H  
 W\*G-TR50-3LS72BP# \$2,257 / \$2,752 Str  
 W\*G-TR49-3LA72BP# \$1,972 / \$2,405 Add  
 End Cap:  
 23" D X 40" W X 52" H – 27 Bins Hold 13-1/2 cases  
 W\*E-TR40-3L27BP# \$994 / \$1,212 End Cap

\*SPECIFY WOOD "O"=OAK, "M"=MAPLE,

"K"=OAK MELAMINE, "E"=MAPLE MELAMINE



## NEWConcept Wine Baskets

Basket options have been added to the NEWConcept Wine Units. Baskets are divided into four sections. Each section holds (9) 3" bottles or (8) 3-1/2" bottles laid down for a total of 24-36 bottles per basket. Choose 2-Basket or 3-Basket Units with shelves or bins above.



### NEW Pull-out Drawer

Pull-out drawer provides a convenient place to store overstock or back-up wine bottles. Drawers are mounted on ballbearing slides for quick and easy access. Makes good use of the space at the bottom of a wine fixture.





Detail of pull-out drawer.



Run of NEWConcept Wine Baskets with pull-out drawer.

## NEWConcept Wine Baskets, Bins and Shelves

Baskets for laid-down bottles, shelves and bins for upright bottles.  
 Bonus pull-out drawer for stock. *See page 167 for more information.*

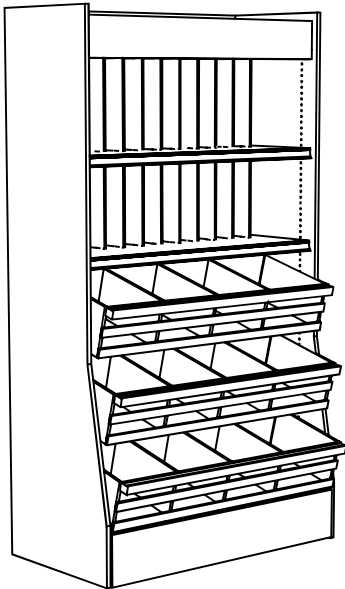

**A. 3-Baskets w/24 Bins** – Holds 24 cases  
 Starter: 30" D x 50" W x 92" H  
 Add-on: 30" D x 49" W x 92" H  
 W\*W-5092-S3B24BT \$1,971.00 / \$2,404.00 / \$1,503.00 Str  
 W\*W-4992-A3B24BT \$1,784.00 / \$2,176.00 / \$1,377.00 Add

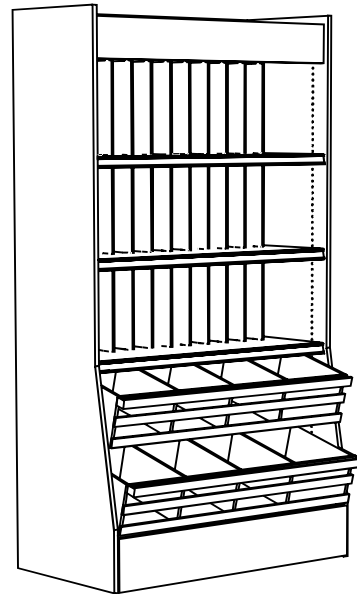

**B. 2-Baskets w/36 Bins** – Holds 26 cases  
 Starter: 30" D x 50" W x 92" H  
 Add-on: 30" D x 49" W x 92" H  
 W\*W-5092-S2B36BT \$1,956.00 / \$2,385.00 / \$1,430.00 Str  
 W\*W-4992-A2B36BT \$1,806.00 / \$2,202.00 / \$1,307.00 Add

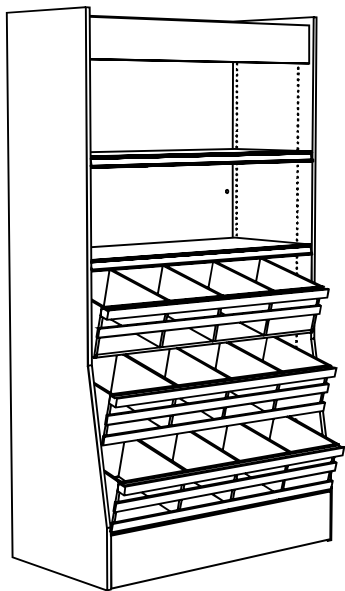

**C. 3-Baskets w/2 Shelves** – Holds 24 cases  
 Starter: 30" D x 50" W x 92" H  
 Add-on: 30" D x 49" W x 92" H  
 W\*W-5092-S3B2HT \$1,765.00 / \$2,152.00 / \$1,396.00 Str  
 W\*W-4992-A3B2HT \$1,616.00 / \$1,971.00 / \$1,270.00 Add

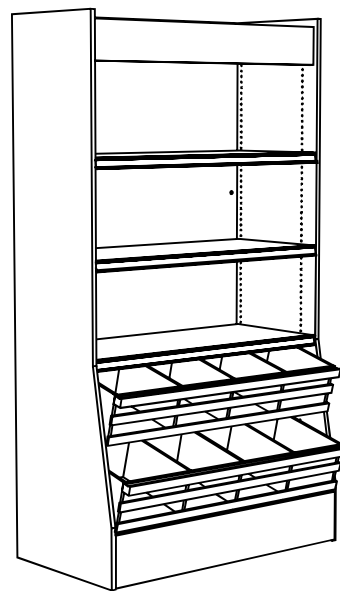

**D. 2-Baskets w/3 Shelves** – Holds 26 cases  
 Starter: 30" D x 50" W x 92" H  
 Add-on: 30" D x 49" W x 92" H  
 W\*W-5092-S2B3HT \$1,661.00 / \$2,026.00 / \$1,282.00 Str  
 W\*W-4992-A2B3HT \$1,475.00 / \$1,799.00 / \$1,158.00 Add

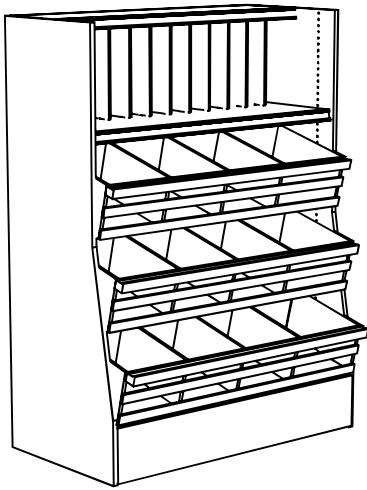

**E. 3-Baskets w/12 Bins** – Holds 18 cases  
 Starter: 30" D x 50" W x 68" H  
 Add-on: 30" D x 49" W x 68" H  
 W\*W-5068-S3B12BT \$1,530.00 / \$1,866.00 / \$1,216.00 Str  
 W\*W-4968-A3B12BT \$1,381.00 / \$1,684.00 / \$1,115.00 Add

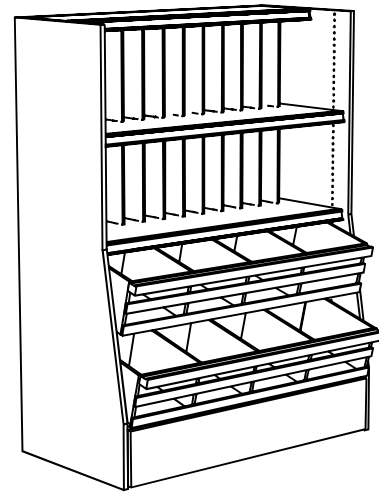

**F. 2-Baskets w/24 Bins** – Holds 20 cases  
 Starter: 30" D x 50" W x 68" H  
 Add-on: 30" D x 49" W x 68" H  
 W\*W-5068-S2B24BT \$1,516.00 / \$1,849.00 / \$1,144.00 Str  
 W\*W-4968-A2B24BT \$1,368.00 / \$1,668.00 / \$1,041.00 Add

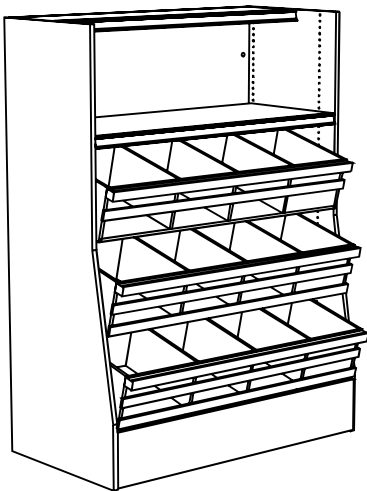

**G. 3-Baskets w/1 Shelf** – Holds 18 cases  
 Starter: 30" D x 50" W x 68" H  
 Add-on: 30" D x 49" W x 68" H  
 W\*W-5068-S3B1HT \$1,439.00 / \$1,755.00 / \$1,170.00 Str  
 W\*W-4968-A3B1HT \$1,291.00 / \$1,574.00 / \$1,070.00 Add

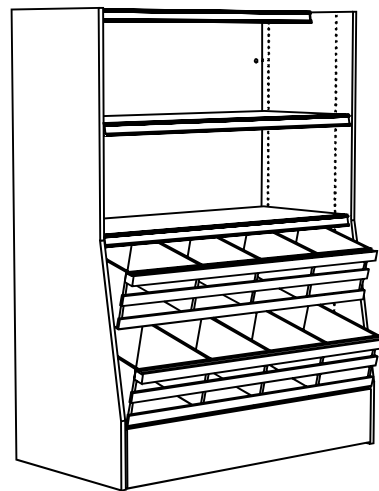

**H. 2-Baskets w/2 Shelves** – Holds 20 cases  
 Starter: 30" D x 50" W x 68" H  
 Add-on: 30" D x 49" W x 68" H  
 W\*W-5068-S2B2HT \$1,334.00 / \$1,627.00 / \$1,054.00 Str  
 W\*W-4968-A2B2HT \$1,188.00 / \$1,449.00 / \$956.00 Add

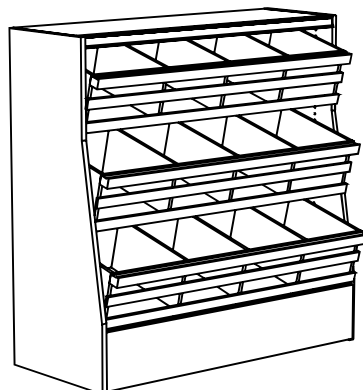

**I. 3-Baskets & Top** – Holds 12 cases  
 Starter: 23" D x 50" W x 52" H  
 Add-on: 23" D x 49" W x 52" H  
 W\*W-5052-S3BT \$1,265.00 / \$1,543.00 / \$1,054.00 Str  
 W\*W-4952-A3BT \$1,136.00 / \$1,385.00 / \$967.00 Add

\*SPECIFY WOOD "O"=OAK, "M"=MAPLE,  
 "K"=OAK MELAMINE, "E"=MAPLE MELAMINE

## Shelving (W\*U)

Starter and Add-on system. Starter units have (2) uprights with no pin holes on outside, add-on units have only (1) upright with pin holes bored through.

Heavy-duty shelves are 1-1/2" thick and hold up to 400 pounds each. Tag moulding option for Shelves. Ships KD.

D = varies with combination  
 W = (36" by quotation), 48"  
 H = 53", 66", 83"



Tag Moulding option for Shelves



Four Shelves w/Backing (W\*U-1S3H-4866SB)

### Optional Heavy Shelves

1-1/2" Thick x 20" D		
S*S-2036-HS	\$89.00 / \$109.00	36" W
S*S-2042-HS	\$107.00 / \$130.00	42" W
S*S-2048-HS	\$110.00 / \$134.00	48" W

### Heavy Shelf w/P5 Tag Moulding

S*S-2036-HSP5	\$91.00 / \$111.00	36" W
S*S-2042-HSP5	\$110.00 / \$134.00	42" W
S*S-2048-HSP5	\$114.00 / \$139.00	48" W

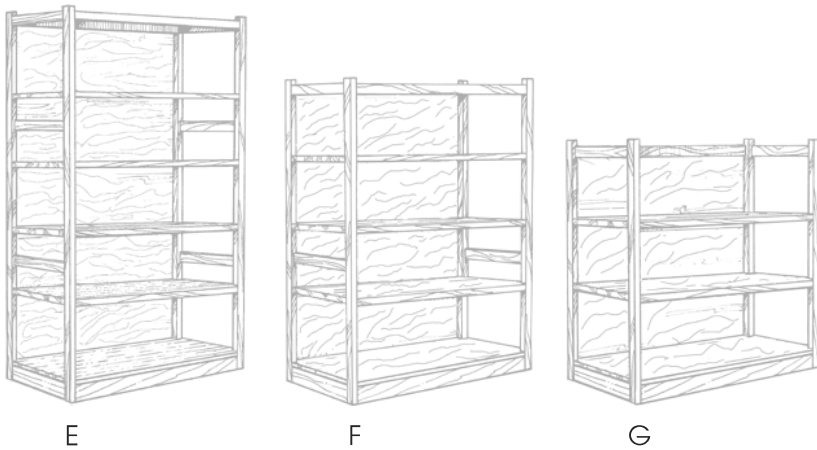

### E. Five Shelves – Holds 35 cases

Starter: 20-1/4" D x 49-1/2" W x 83" H

Add-on: 20-1/4" D x 48" W x 83" H

W*U-1S4H-4883SB	\$1,080.00 / \$1,317.00	Starter w/Back
W*U-1S4H-4883AB	\$921.00 / \$1,123.00	Add-on w/Back
W*U-1S4H-4883S	\$905.00 / \$1,104.00	Starter
W*U-1S4H-4883A	\$746.00 / \$910.00	Add-on

42" W End Cap w/Back

W\*U-1S4H-4283EB \$1,040.00 / \$1,268.00

#### w/P5 Tag Moulding on Shelves

W*U-1S4H-4883SBP5	\$1,115.00 / \$1,360.00	Starter w/Back
W*U-1S4H-4883ABP5	\$956.00 / \$1,166.00	Add-on w/Back
W*U-1S4H-4883SP5	\$970.00 / \$1,183.00	Starter
W*U-1S4H-4883AP5	\$780.00 / \$951.00	Add-on

42" W End Cap w/Back

W\*U-1S4H-4283EBP5 \$1,085.00 / \$1,323.00

### F. Four Shelves – Holds 28 cases

Starter: 20-1/4" D x 49-1/2" W x 66" H

Add-on: 20-1/4" D x 48" W x 66" H

W*U-1S3H-4866SB	\$881.00 / \$1,074.00	Starter w/Back
W*U-1S3H-4866AB	\$758.00 / \$924.00	Add-on w/Back
W*U-1S3H-4866S	\$737.00 / \$899.00	Starter
W*U-1S3H-4866A	\$614.00 / \$749.00	Add-on

42" W End Cap w/Backing

W\*U-1S3H-4266EB \$846.00 / \$1,032.00

#### w/P5 Tag Moulding on Shelves

W*U-1S3H-4866SBP5	\$912.00 / \$1,112.00	Starter w/Back
W*U-1S3H-4866ABP5	\$789.00 / \$962.00	Add-on w/Back
W*U-1S3H-4866SP5	\$767.00 / \$935.00	Starter
W*U-1S3H-4866AP5	\$645.00 / \$787.00	Add-on

42" W End Cap w/Backing

W\*U-1S3H-4266EBP5 \$876.00 / \$1,068.00

### G. Three Shelves – Holds 21 cases

Starter: 20-1/4" D x 49-1/2" W x 53" H

Add-on: 20-1/4" D x 48" W x 53" H

W*U-1S2H-4853SB	\$704.00 / \$859.00	Starter w/Back
W*U-1S2H-4853AB	\$601.00 / \$733.00	Add-on w/Back
W*U-1S2H-4853S	\$586.00 / \$715.00	Starter
W*U-1S2H-4853A	\$483.00 / \$589.00	Add-on

42" W End Cap w/Back

W\*U-1S2H-4253EB \$674.00 / \$822.00

#### w/P5 Tag Moulding on Shelves

W*U-1S2H-4853SBP5	\$730.00 / \$890.00	Starter w/Back
W*U-1S2H-4853ABP5	\$626.00 / \$763.00	Add-on w/Back
W*U-1S2H-4853SP5	\$612.00 / \$746.00	Starter
W*U-1S2H-4853AP5	\$508.00 / \$620.00	Add-on

42" W End Cap w/Back

W\*U-1S2H-4253EBP5 \$706.00 / \$861.00



5-level starter w 15" Shelves and (20) Bottle Shelves:  
w/(20) Metal Display Bottle Holders: \$1,646.00 / \$1,176.00



5-level starter w 19" Shelves:  
As Shown: wo/Metal Display Bottle Holders: \$1,213.00 / \$759.00  
w/(20) Metal Display Bottle Holders: \$1,373.00 / \$919.00

## Wine Bin Cabinet (W\*C)

15" or 19" D shelves. Use Display Bottle Shelf option with 15" shelves only (top left). 19" shelves extend out 4" for display bottle (bottom left). Use optional Metal Bottle Holder with either 15" or 19" shelves. Each bin holds 12 bottles laid-down. Starter and add-on units. Ships KD.

Cabinets priced without optional Bottle Holders

**6-level 24 Bins w/15" Shelves** – Holds 24 cases

Starter: 20-1/4" D x 47-3/4" W x 95-1/4" H

Add-on: 20-1/4" D x 47" W x 95-1/4" H

W\*C-2048-6LS24B15 \$1,268.00 / \$1,546.00 / \$741.00 Starter

W\*C-2048-6LA24B15 \$1,159.00 / \$1,413.00 / \$677.00 Add-on

**5-level 20 Bins w/15" Shelves** – Holds 20 cases

Starter: 20-1/4" D x 47-3/4" W x 80-1/4" H

Add-on: 20-1/4" D x 47" W x 80-1/4" H

W\*C-2048-5LS20B15 \$1,130.00 / \$1,378.00 / \$660.00 Starter

W\*C-2048-5LA20B15 \$1,013.00 / \$1,235.00 / \$592.00 Add-on

**4-level 16 Bins w/15" Shelves** – Holds 16 cases

Starter: 20-1/4" D x 47-3/4" W x 65" H

Add-on: 20-1/4" D x 47" W x 65" H

W\*C-2048-4LS16B15 \$942.00 / \$1,149.00 / \$550.00 Starter

W\*C-2048-4LA16B15 \$845.00 / \$1,030.00 / \$494.00 Add-on

**3-level 12 Bins w/15" Shelves** – Holds 12 cases

Starter: 20-1/4" D x 47-3/4" W x 49-3/4" H

Add-on: 20-1/4" D x 47" W x 49-3/4" H

W\*C-2048-3LS12B15 \$752.00 / \$917.00 / \$440.00 Starter

W\*C-2048-3LA12B15 \$675.00 / \$823.00 / \$395.00 Add-on



### Display Bottle Shelf

W\*C-WINE-SHELFW \$18.00 / \$22.00

### Display Bottle Shelf for base shelf

W\*C-WINE-BASEW \$17.00 / \$21.00

### Metal Display Bottle Holder

FIX-WINE-HOLD \$8.00

Each bin holds one case

**6-level 24 Bins w/19" Shelves** – Holds 24 cases

Starter: 20-1/4" D x 47-3/4" W x 95-1/4" H

Add-on: 20-1/4" D x 47" W x 95-1/4" H

W\*C-2048-6LS24B19 \$1,360.00 / \$1,659.00 / \$795.00 Starter

W\*C-2048-6LA24B19 \$1,226.00 / \$1,495.00 / \$716.00 Add-on

**5-level 20 Bins w/19" Shelves** – Holds 20 cases

Starter: 20-1/4" D x 47-3/4" W x 80-1/4" H

Add-on: 20-1/4" D x 47" W x 80-1/4" H

W\*C-2048-5LS20B19 \$1,213.00 / \$1,479.00 / \$759.00 Starter

W\*C-2048-5LA20B19 \$1,088.00 / \$1,327.00 / \$635.00 Add-on

**4-level 16 Bins w/19" Shelves** – Holds 16 cases

Starter: 20-1/4" D x 47-3/4" W x 65" H

Add-on: 20-1/4" D x 47" W x 65" H

W\*C-2048-4LS16B19 \$998.00 / \$1,217.00 / \$586.00 Starter

W\*C-2048-4LA16B19 \$903.00 / \$1,101.00 / \$533.00 Add-on

**3-level 12 Bins w/19" Shelves** – Holds 12 cases

Starter: 20-1/4" D x 47-3/4" W x 49-3/4" H

Add-on: 20-1/4" D x 47" W x 49-3/4" H

W\*C-2048-3LS12B19 \$789.00 / \$962.00 / \$461.00 Starter

W\*C-2048-3LA12B19 \$713.00 / \$870.00 / \$417.00 Add-on

\*SPECIFY WOOD "O"=OAK, "M"=MAPLE,  
"K"=OAK MELAMINE, "E"=MAPLE MELAMINE



### Wine Island (W\*I)

For laid-down wine. Wine Island holds stacks of 13 bottles up to 3-3/8" diameter. Scalloped holders on top for display bottles above each stack. Optional Shelf for half case. Ships assembled or KD.



Wine Islands and custom Wine Tower.

### Double-sided Island

23-7/8" D x 47-3/4" W x 47-7/8" H  
 24 stacks plus 24 display = 336 bottles  
 W\*I-2448-4800 \$1,111.00 / \$1,355.00 / \$809.00  
 W\*I-2448-4800KD \$1,169.00 / \$1,426.00 / \$851.00

### Single-sided Island

12-1/2" D x 47-3/4" W x 47-7/8" H  
 12 stacks plus 12 display = 168 bottles  
 W\*I-1248-4800 \$596.00 / \$727.00 / \$472.00  
 W\*I-1248-4800KD \$627.00 / \$765.00 / \$437.00

### End Cap Island

12-1/2" D x 24-1/2" W x 47-7/8" H  
 6 stacks plus 6 display = 84 bottles  
 W\*I-1224-4800 \$386.00 / \$471.00 / \$290.00  
 W\*I-1224-4800KD \$406.00 / \$495.00 / \$305.00

### Optional Shelf for half case

1/2" X 7" D x 3" W  
 W\*I-SH \$4.00 / \$5.00 / \$3.00

prices: \$ wood / \$ stain / \$ melamine



### Tiered Wine Rack (W\*T)

Display one bottle above for selection and one upright bottle in front of four laid-down bottles for stock. Holds up to 24 half cases or 12 full cases of different varieties. Ships assembled or KD.

#### Tiered Wine Rack

Single-sided

18" D x 47-3/4" W x 47-3/4" H

W\*T-1848-48 \$910.00 / \$1,110.00 / \$572.00

W\*T-1848-48KD \$957.00 / \$1,167.00 / \$602.00

Double-sided

42" D x 47-3/4" W x 47-3/4" H

W\*T-4248-4800KD \$1,833.00 / \$2,235.00 / \$1,196.00

Tiered Wine Rack for Magnums - call for specifications and pricing

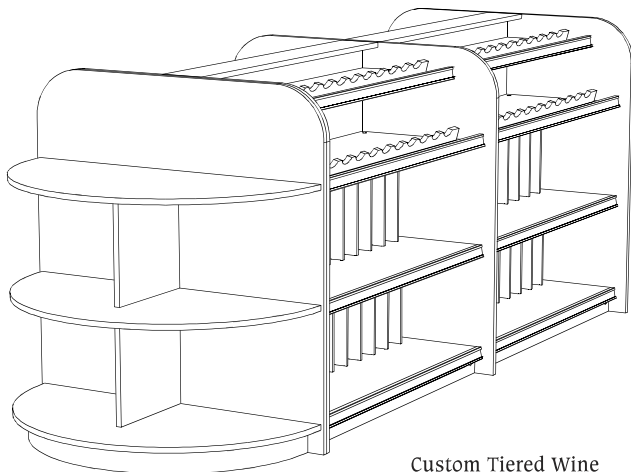

Custom Tiered Wine Racks w/End Cap.



\*SPECIFY WOOD "O"=OAK, "M"=MAPLE,  
"K"=OAK MELAMINE, "E"=MAPLE MELAMINE